

NOTES:

1. SUBSTRATE
UV GRADE FUSED SILICA
2. CENTERING TOLERANCE:
PLANO AXIS WEDGE: <3 ARCMIN
POWER AXIS WEDGE: <3 ARCMIN
AXIAL TWIST: <3 ARCMIN
3. COATING (APPLY ACROSS COATING APERTURE)
S1 & S2: 266nm AR Coated
R(ABS) < 0.25% @ 266nm @ 0° AOI

DAMAGE THRESHOLD
PULSED: 3 J/cm², 20ns, 20 Hz @ 266nm

4. FINE GROUND SURFACE

5. RoHS COMPLIANT

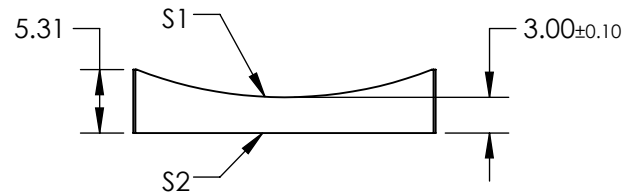
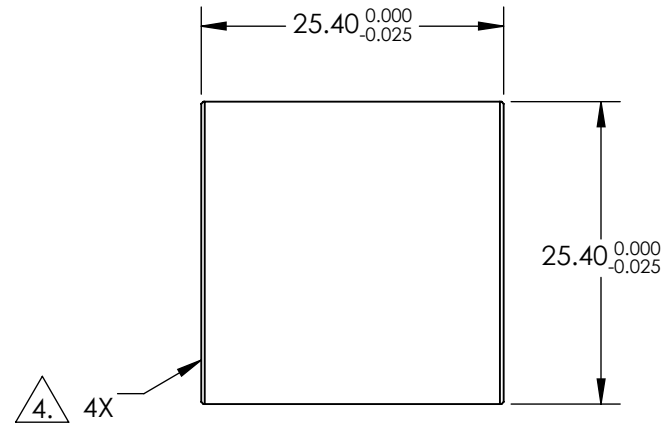
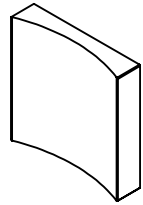

**FOR INFORMATION ONLY:
DO NOT MANUFACTURE
PARTS TO THIS DRAWING**

| | S1 | S2 |
|-------------------------|----------------------|----------------------|
| SHAPE | CONCAVE | PLANO |
| RADIUS | 34.39 | INFINITY |
| SURFACE QUALITY | 20 - 10 | 20 - 10 |
| CLEAR APERTURE | 22.86 X 22.86 | 22.86 X 22.86 |
| COATING APERTURE | 24.40 x 24.40 | 24.40 x 24.40 |
| POWER AT 632.8nm | 1.50 WAVES | 1.50 WAVES |
| IRREGULARITY AT 632.8nm | 0.25 WAVES | 0.25 WAVES |
| BEVEL | PROTECTIVE AS NEEDED | PROTECTIVE AS NEEDED |

SPECIFICATIONS SUBJECT TO CHANGE WITHOUT NOTICE
DIMENSIONS ARE FOR REFERENCE ONLY

| | | | |
|------------------------|--------|--------|---|
| EFL | -75.00 | | Edmund Optics® |
| BFL | -77.06 | | |
| THIRD ANGLE PROJECTION | | TITLE | BEAM SHAPING CYLINDER LENS, FUSED SILICA, 25.4mm SQ X -75mm EFL, AR COATED |
| ALL DIMS IN | mm | DWG NO | 37580 |
| | | | SHEET 1 OF 1 |