

NOTES:

1. SUBSTRATE: N-BK7
2. S2 TO BE PARALLEL WITH S1 TO <1 ARCMIN
3. COATING (APPLY ACROSS CLEAR APERTURE)

S1: YAG-BBAR (500-1100nm)
 S2: YAG-BBAR (500-1100nm)
 Rabs <0.25% @ 532nm Rabs <0.25% @ 1064nm Ravg <1.0% @ 500 - 1100nm

4. FINE GRIND SURFACE

5. ROHS COMPLIANT

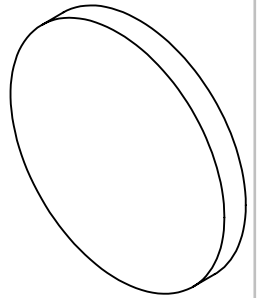
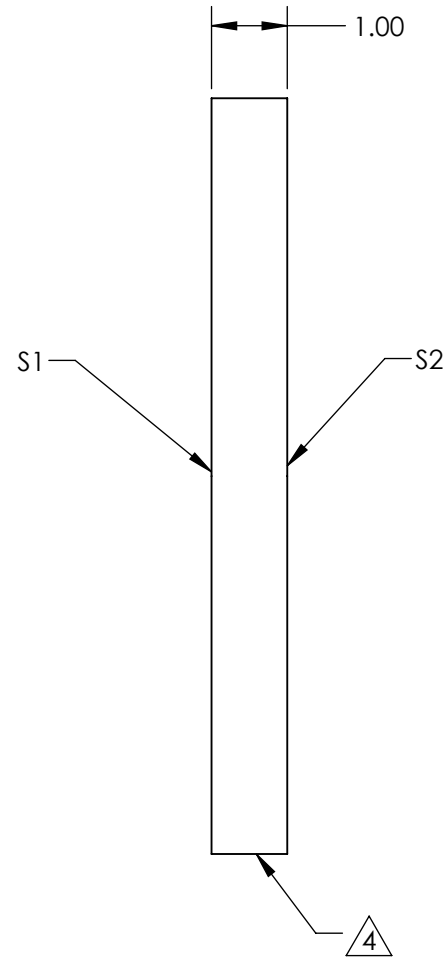
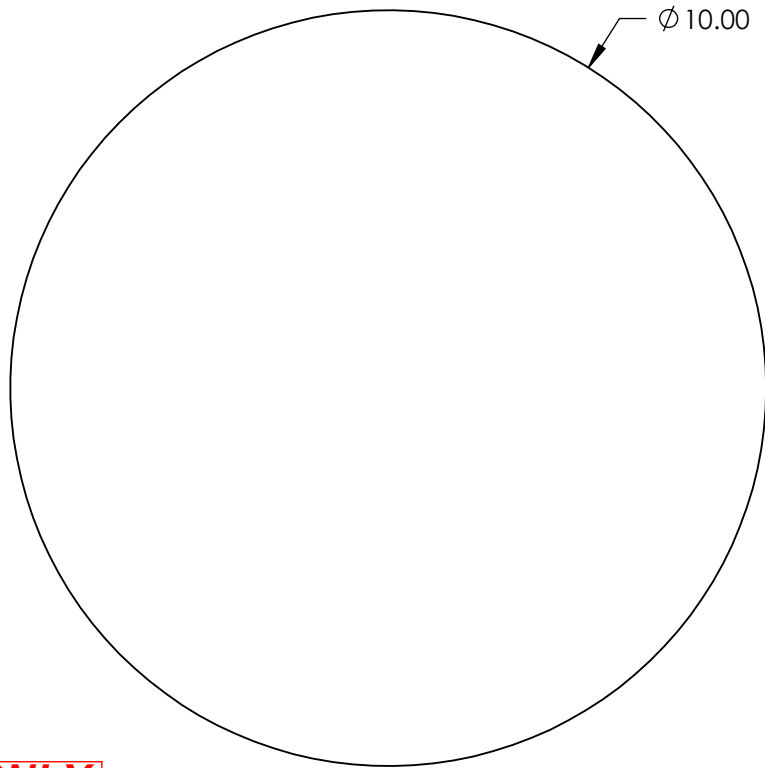

**FOR INFORMATION ONLY:
 DO NOT MANUFACTURE
 PARTS TO THIS DRAWING**

SPECIFICATIONS SUBJECT TO CHANGE WITHOUT NOTICE
 DIMENSIONS ARE FOR REFERENCE ONLY

	S1	S2
SHAPE	PLANO	PLANO
SURFACE QUALITY	60-40	60-40
CLEAR APERTURE	$\phi 9.00$	$\phi 9.00$
BEVEL	PROTECTED AS NEEDED	PROTECTED AS NEEDED

THIRD ANGLE PROJECTION

ALL DIMS IN mm

Edmund Optics®

TITLE

10mm Dia., 1mm Thick, YAG-BBAR Coated
 $\lambda/4$ N-BK7 Window

DWG NO

23467

SHEET
 73 OF 84