

NOTES:

1. SUBSTRATE:
FUSED SILICA (CORNING 7980)
2. S1 TO BE PARALLEL WITH S2 TO WITHIN <1 ARCMIN
3. COATING (APPLY ACROSS CLEAR APERTURE)
S1 & S2: UV-VIS (250-700nm)
R(ABS) ≤1.0% @ 350 - 450nm
R(AVG) ≤1.5% @ 250 - 700nm

4. FINE GRIND SURFACE

5. ROHS COMPLIANT

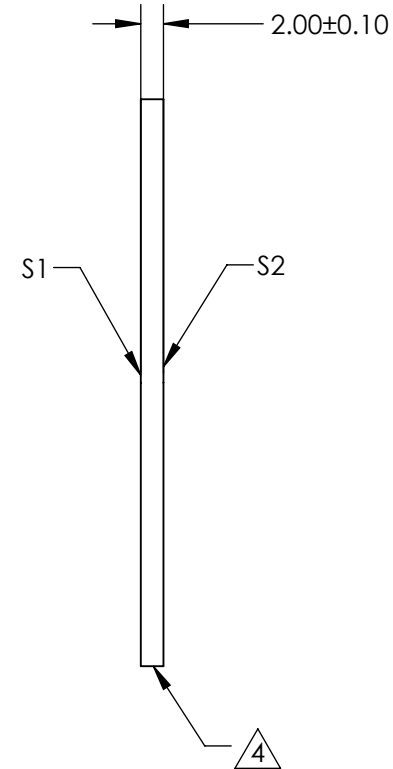
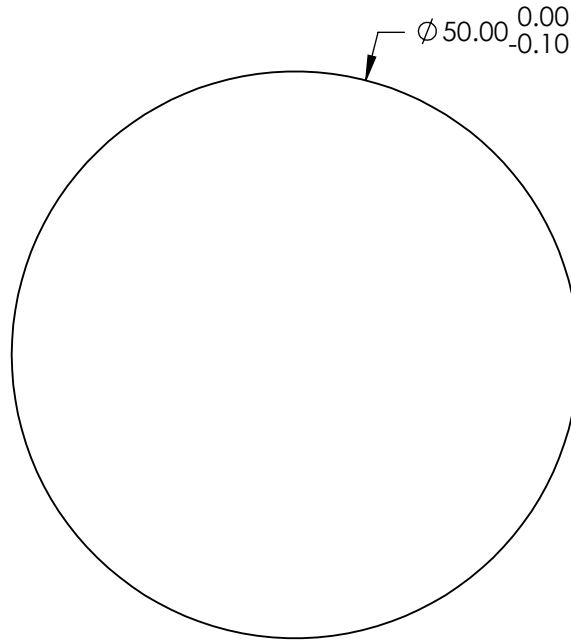
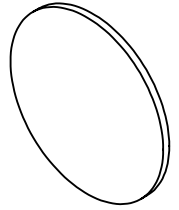

**FOR INFORMATION ONLY:
DO NOT MANUFACTURE
PARTS TO THIS DRAWING**

SPECIFICATIONS SUBJECT TO CHANGE WITHOUT NOTICE
DIMENSIONS ARE FOR REFERENCE ONLY

| | S1 | S2 |
|-----------------|---------------------|---------------------|
| SHAPE | PLANO | PLANO |
| SURFACE QUALITY | 40 - 20 | 40 - 20 |
| CLEAR APERTURE | $\phi 45.00$ | $\phi 45.00$ |
| BEVEL | PROTECTED AS NEEDED | PROTECTED AS NEEDED |

THIRD ANGLE PROJECTION

ALL DIMS IN mm

Edmund Optics®

TITLE

50mm Dia., 2mm Thick, UV-VIS Coated, $\lambda/4$
Fused Silica Window

DWG NO

72408

SHEET
68 OF 84